

7,600 SF RESTAURANT FOR LEASE
1765 ALA MOANA BLVD
HONOLULU, HAWAII



WAIKIKI MAP



1765 ALA MOANA BOULEVARD **SPACE PLAN**



RESTAURANT OPPORTUNITY 7,600 SF
CONTACT FOR AVAILABILITY

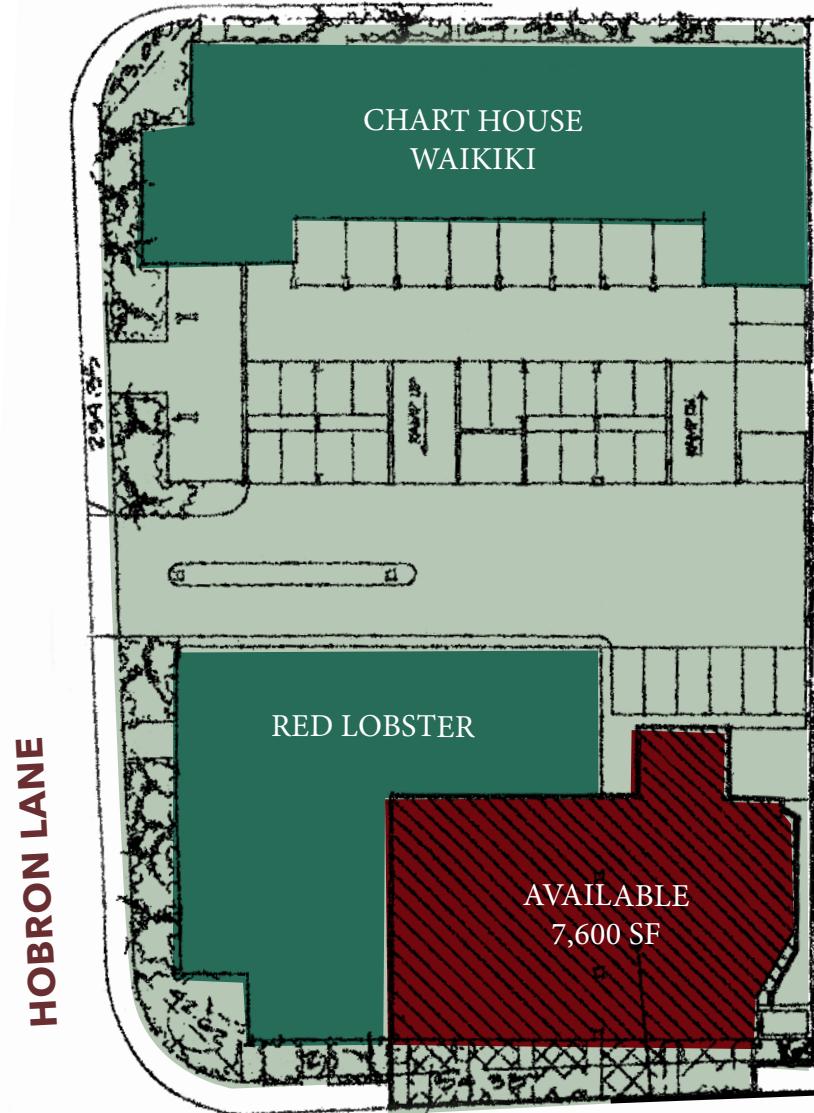

HAWAII
PRINCE
HOTEL

ALA MOANA BLVD



CHRIS YARIS (S), SENIOR VICE PRESIDENT
(808) 469-4337
CHRIS@THEBEALLCORPORATION.COM

JULIA MATSUURA (S), VICE PRESIDENT
(808) 469-4308
JULIA@THEBEALLCORPORATION.COM

1765 ALA MOANA BOULEVARD **II** INTERIOR



3 BEALL CORP
RETAIL REAL ESTATE

CHRIS YARIS (S), SENIOR VICE PRESIDENT
(808) 469-4337
CHRIS@THEBEALLCORPORATION.COM

JULIA MATSUURA (S), VICE PRESIDENT
(808) 469-4308
JULIA@THEBEALLCORPORATION.COM

VISITOR MARKET HIGHLIGHTS

- 30,000 visitor lodging units, including 23,000+ hotel rooms
- Average Daily Visitor Population exceeds 75,000
- Average Daily Local Population: 31,300 residents and 39,955 employees
- 1.5 - 1.7 Million Square Feet of Retail GLA
- Waikiki Retailers: Gucci, Hermes, Prada, Fendi, Cartier, Jimmy Choo, Valentino, Loro Piano, Harry Winston, Bvlgari, Salvatore Ferragamo,

Louis Vuitton, Apple, DFS, Tiffany & Co., Tory Burch, UGG, Kate Spade, H&M, Urban Outfitters, Victoria's Secret, Ross, Macy's, Quiksilver, Long's Drugs, Volcom and many more

- Waikiki Restaurants: Cheesecake Factory, Tommy Bahama, PF Chang's, Hard Rock Café, Ruth's Chris Steakhouse, Yard House, Duke's Waikiki, Maui Brewing Company, Roy's Waikiki, California Pizza Kitchen, Morimoto Asia and many more

This document has been prepared by The Beall Corporation for advertising and general information only. The Beall Corporation makes no guarantees, representations or warranties of any kind, expressed or implied, regarding the information including, but not limited to, warranties of content, accuracy and reliability. Any interested party should undertake their own inquiries as to the accuracy of the information. The Beall Corporation excludes unequivocally all inferred or implied terms, conditions and warranties arising out of this document and excludes all liability for loss and damages arising there from. This publication is the copyrighted property of The Beall Corporation and/or its licensor(s). © Copyright 2022. All rights reserved.



Scan or visit eepurl.com/c2rzHH to sign up for The Beall Corporation Newsletters and stay on top of Hawaii's Commercial Real Estate News

WWW.THEBEALLCORPORATION.COM

1120 12TH AVENUE, SUITE 301 | HONOLULU, HI 96816

BEALL CORP
RETAIL REAL ESTATE