

THE WESTIN HAPUNA BEACH RESORT

62-100 KAUNA'OA DRIVE
RETAIL SPACE

KOHALA COAST, HAWAII



SETH MCCORMACK (S)
(808) 469-4308
SETH@THEBEALLCORPORATION.COM



62-100 KAUNA'OA DRIVE



PROPERTY OVERVIEW

Westin Hotels & Resorts first appearance on the Island of Hawaii comes with a signed franchise agreement with Mauna Kea Resorts. Donn Takashi, President of Prince Resorts Hawaii positively confirms this operation in a written statement "Well-being is a big part of the local culture here, so we couldn't be more excited to bring the Westin brand to the island of Hawaii." This franchise agreement entails a \$46 million renovation beginning late August 2017 and completion March 2018. Upon the completion of Hapuna's renovations, the resort will hold the title The Westin Hapuna Beach Resort, but will also remain part of the Prince Resorts Hawaii.

AREA HIGHLIGHTS

- The Kohala Coast includes 5,210 visitor units within 5 major world-class resorts, including Waikoloa, Mauna Kea, Mauna Lani, Four Seasons Hualala and Kukio
- Close proximity to Kailua-Kona and an additional 4,387 visitor units
- Big Island Total Population: 186,738

SETH MCCORMACK (S)
 (808) 469-4308
 SETH@THEBEALLCORPORATION.COM



62-100 KAUNA'OA DRIVE • SITE PLAN

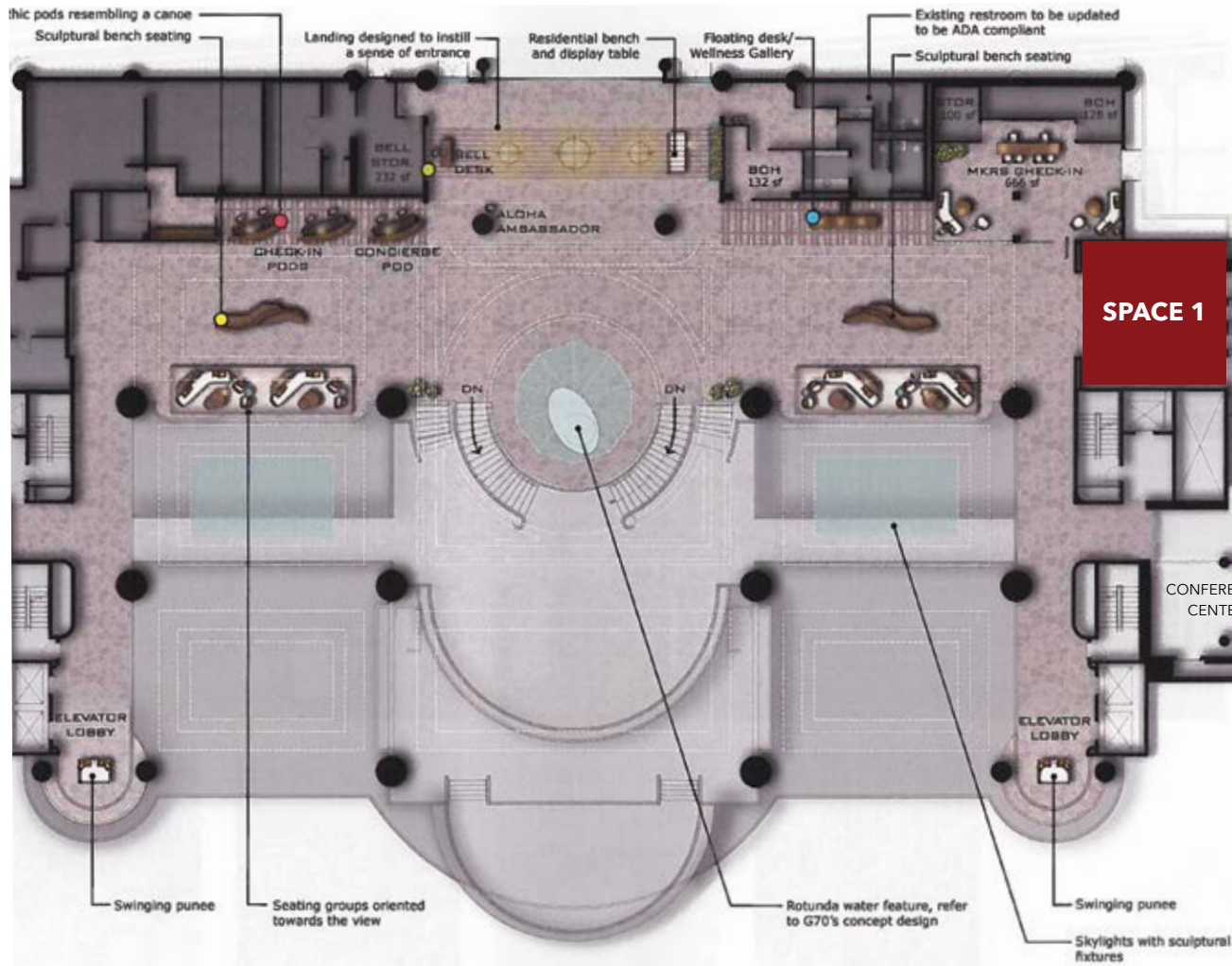

AVAILABLE SPACES

SPACE 1	770 SF
SPACE 2	1,200 SF
SPACE 3	2,236 SF

SPACE 1

SPACE 2

SPACE 3

CONFERENCE CENTER

SETH MCCORMACK (S)
 (808) 469-4308
 SETH@THEBEALLCORPORATION.COM



62-100 KAUNA'OA DRIVE



SETH MCCORMACK (S)
(808) 469-4308
SETH@THEBEALLCORPORATION.COM



Scan or visit eepurl.com/cYstrT to sign up for
The Beall Corporation Newsletters and stay
on top of Hawaii's Commercial Real Estate News

